



FLAT 1
BOURNEMOUTH CENTRE
Dorset, BH2 5SU

£775 PCM

goadsby.com

ONE BEDROOM GROUND FLOOR APARTMENT WITH PRIVATE PATIO SPACE CLOSE TO THE TOWN CENTRE.

- One Bedroom Ground Floor Flat
- Offered Furnished
- Private Patio
- Close To The Town Centre
- EPC Rating: Band C



Energy Efficiency Rating	
Current	Potential
Very energy efficient - lower running costs	
A (92-100)	
B (81-91)	
C (69-80)	72 75
D (55-68)	
E (39-54)	
F (21-38)	
G (1-20)	
Not energy efficient - higher running costs	

England, Scotland & Wales
EU Directive 2002/91/EC

Reference: 253801

Deposit Amount: 894.23

Council Tax: Band A

Furnishing: Furnished

Heating Type: Gas fired hot water radiators

Parking: No Parking

Utilities:

- Mains Supply Electricity
- Mains Supply Gas
- Mains Supply Water - metered

Drainage: Mains Supply Drainage

Broadband: Refer to Ofcom website
www.ofcom.org.uk/phones-and-broadband

Mobile Signal: Refer to Ofcom website
www.ofcom.org.uk/phones-and-broadband

Flood Risk: For more information refer to
gov.uk, check long term flood risk
www.gov.uk/check-long-term-flood-risk

This one bedroom ground floor apartment is located on Suffolk Road, and is just a short walk from the town centre and its array of local amenities and cosmopolitan restaurants, and is also easily accessible to the Bournemouth pleasure gardens. The property is accessed into a large open plan kitchen/living room with a large bay window facing out to the road side. There is then a small hallway which accesses an additional storage cupboard, the bathroom with shower fitted over bath, and the bedroom. In addition there is a private patio space which is accessed from the bedroom. The property is offered on a furnished basis. No parking included.

GROUND FLOOR

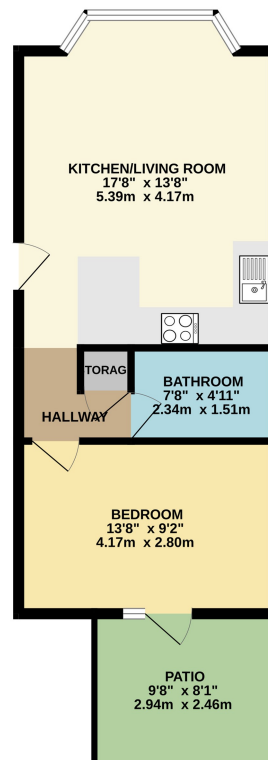

PLEASE NOTE:

Measurements quoted are approximate and for guidance only. Fixtures, fittings, services & appliances have not been tested and therefore no guarantee can be given that they are in working order. Images have been produced for information and it cannot be inferred that any item shown is included with the property. These particulars are believed to be correct but their accuracy is not guaranteed and they do not constitute an offer or form part of a contract. Solicitors are specifically requested to verify the sales particulars details in the pre-contract enquiries, in particular: price, local and other searches.

This Floor Plan is for guidance only and is NOT to SCALE
Made with Metropix ©2024

Goadsby & Harding (Residential) Ltd
Registered Office: 99 Holdenhurst Road, Bournemouth, Dorset BH8 8DY Registered in England No. 1871280

01202 544644
bournemouthlettings@goadsby.com

114 Old Christchurch Road
Bournemouth, Dorset
BH1 1LU