



Lansdowne

WELL PRESENTED ONE BEDROOM APARTMENT CENTRALLY
LOCATED

EPC Rating: Band B

£140,000 Leasehold

goadsby

goadsby.com



**Lansdowne Mews,
Bournemouth. BH1 1SJ**

WITHIN WALKING DISTANCE OF
AWARD WINNING BEACHES

- Secure Entryphone System
 - Sitting/Dining Room
 - Kitchen
 - One Double Bedroom
- Gas Central Heating & Double Glazing

(Ref: 895170)

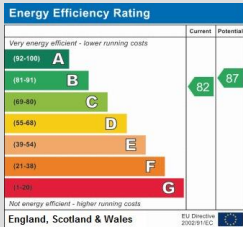

This well presented apartment is situated in Bournemouth Town Centre within easy reach of shops, bars and restaurants together with the travel interchange and award winning sandy beaches.

The block is accessed via secure entry phone system with stairs ascending to the first floor.

Upon entering the apartment you are welcomed into a spacious hallway with doors leading to all principle rooms.

The sitting/dining room offers ample space for both living and dining furniture with a dual aspect providing a bright and airy outlook.

The kitchen benefits from a range of base and wall mounted units as well as space for white goods and appliances.

The bedroom is a double and provides space for a range of furniture and is served by the family bathroom comprising bath, wash hand basin and WC.

Further benefits include gas central heating and double glazed windows.

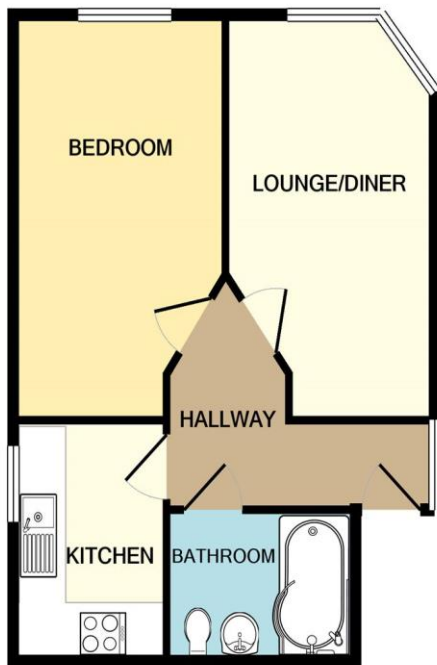

This Floor Plan is for guidance only and is NOT to SCALE
Made with Metropix ©2020

Sitting/Dining Room
4.82m (15'10) max x
2.78m (9'1) max

Kitchen
2.8m (9'2) x 1.98m
(6'6)

Bedroom
4.78m (15'8) max x
2.76m (9'1) max

Brochure prepared by Charlotte Anning

PLEASE NOTE Measurements quoted are approximate and for guidance only. Fixtures, fittings, services & appliances have not been tested and therefore no guarantee can be given that they are in working order. Images have been produced for information and it cannot be inferred that any item shown is included with the property. These particulars are believed to be correct but their accuracy is not guaranteed and they do not constitute an offer or form part of a contract. Solicitors are specifically requested to verify the sales particulars details in the pre-contract enquiries, in particular: price, local and other searches.

Goadsby & Harding (Residential) Ltd Registered Office: 99 Holdenhurst Road, Bournemouth, Dorset BH8 8DY Registered in England No. 1871280

G341 Printed by Ravensworth 01670 713330

BOURNEMOUTH
109 Old Christchurch Road
Bournemouth, Dorset, BH1 1EP
t: 01202 544666
e: bournemouth@goadsby.com

